



# GRESFORD PARK TRUST

ABN 9866 366 2102

PO Box 1 East Gresford NSW 2311

PRESIDENT - Mr R. Richardson SECRETARY – Mrs R. Wall ( Ph 4938 9462 \* Fx 4938 9610 )

TRUSTEES - Mr T Capp, Mr S. Everett, Mrs R. Lawrence, Fr S Moore,

Email – rose.wall@bigpond.com

## Newsletter No 2 – June 2012

### MANAGEMENT PLAN REVIEW

The final draft of the Management Plan including our fee review will be ready to distribute to Ground Users shortly. After it is distributed, the Trust will organise another ground users meeting to garner your thoughts on the document and its contents.

### ENTRANCE UPGRADE

We are still working on this project and have progressed to the stage of obtaining final quotations for the project and will submit an application for grant funding assistance to complete the project as soon as possible. The design will incorporate the original pillars that our archives reveal were constructed in 1946 to accommodate 2 x 9 foot lockable gates at the entrance to the Park. The original gate construction was the result of collaboration between the Gresford Park Trust and Gresford Show Society with the Trust resolving to allocate “no more than £50” to the construction. The gates were subsequently moved from their Park Street location to the cattle grid when it was discovered that the roadway was actually Council land.



### NAME THAT ROAD!

We now have a wide selection of road names to choose from as follows

Orana Lane	Pioneer Drive	Recreation Avenue
Townshend Lane	Champaign Ave	Cottonwood Drive
Showground Ave	Memorial Ave	

We will be asking representatives at our user group meeting to choose 3 preferred names to submit to Council so we can move forward with this project so please discuss the options and if you wish to suggest any others, let us know as soon as possible so your thoughts can be included.

### PRMF GRANTS

Public Reserve Management Fund grant applications for 2012-2013 are currently open. Details of the criteria for funding can be found at [http://www.lpma.nsw.gov.au/crown\\_land/crown\\_reserves/funding/prmf-funding](http://www.lpma.nsw.gov.au/crown_land/crown_reserves/funding/prmf-funding) (press Ctrl button and click to follow the link). The closing dates for applications, is nominated as the 31<sup>st</sup> of July 2012 so if you have any pending projects that may be eligible for funding please contact one of the Trust members listed above to discuss your project.

### VOLUNTEER SMALL EQUIPMENT GRANTS

The 2012 Volunteer Small Equipment Grant also opened on the 1<sup>st</sup> June and closes on Wednesday 25<sup>th</sup> July. Information on this grant & application forms can be found at the following link (press Ctrl button and click to follow the link) <http://www.fahcsia.gov.au/about/news/2012/Pages/vg2012.aspx>

## RIVERBANK STABILISATION

Gresford Landcare Group has now completed the riverbank stabilisation project which included removal of woody weeds, planting a mixture of trees, shrubs and Lomandra and a rebuild of the steps leading down to the swimming hole. Their efforts, in combination with the Trusts Weed Spraying Program have created a very idyllic outlook for anyone visiting the Park. The Trust is very keen to keep the Park as weed free as we can so if you notice any problem growth please advise Scott Everett so he can add it to the list of scheduled sprays.

## CAMPING LEVELS

Occupancy rates of the Camping Area at the Park have continued to increase over the past 12 months with Powered sites and Campervan Club usage both showing an increase of 80%. Unpowered site usage has also increased by 11%. This increase in popularity has inspired the Trust to expand the current camping area slightly by cleaning up the area below the middle toilets and improving the drainage in that area as well. This project will commence very shortly. A very rough mud-map indicating various target areas for these improvements and other projects is attached to this newsletter.

## VANDALISM

The Park and the user group facilities was once again the target of a vandalism attack in late March. Doors to the Produce pavilion and BBQ Rooms were both kicked in and smashed and panelling on the Pony Club rooms were also attacked and suffered significant damage. The vandals also snapped a tap riser off at ground level in the vicinity of the Pony Club rooms resulting in the surrounding area being badly flooded. Police were very quick to act and have charged a Maitland man with the offences, however the case is still pending a court hearing.

## A LITTLE BIT OF HISTORY.....

The archives held by the Trust provide interesting insight into the various usages of the grounds over the years and the gradual development and addition of the facilities now present. The archives mention Golf Links, concrete Cricket Pitches, Football Goal Posts, Race Days, Agricultural Shows, Rodeo's, Sports Days and the occupation of the grounds by the "Military Authorities" in 1942. On the 8<sup>th</sup> February 1947 the trust received a letter from Mr Don Crouch, secretary of the "River View Tennis Club" advising that their club had *"a membership of twenty three members and numerous other applications to join, but we feel that we have at present enough members for our own court use and also are not in a position to build another court"* the letter goes on to say *"The feeling of the above club is that this town should have a public court or courts to cater for the overflow of tennis players that are in this district at the present time"*

The Trustees at the time considered the request and *"Proposed that the Trustees consider the expenditure of £100 for the construction of two tennis courts to approved specifications subject to a guarantee from the public that any additional costs of construction required, to be found by them and an undertaking to maintain the said courts in a satisfactory condition."* The first two Tennis Courts were eventually built although not without some teething problems. A letter to the Trust in 1949 reveals that in an effort to save £12 at the time of construction, the "high wall" was not "tied back" as was advised by the builder Mr Hancock at the time and had subsequently started to lean & that the situation needed to be rectified before it was too late.

The first agreement between the Tennis Club & Park Trust *"giving the Court Committee power to administer the Courts"* was subject to an annual rental of £2. Permission to build the original "Shed" on the North side of the courts between *"the court fence and Richardson's boundary fence"* was granted in May 1952. The additional courts were approved and built in 1975/6.

# Gresford Park Asset & Infrastructure Improvement Program Stage 3

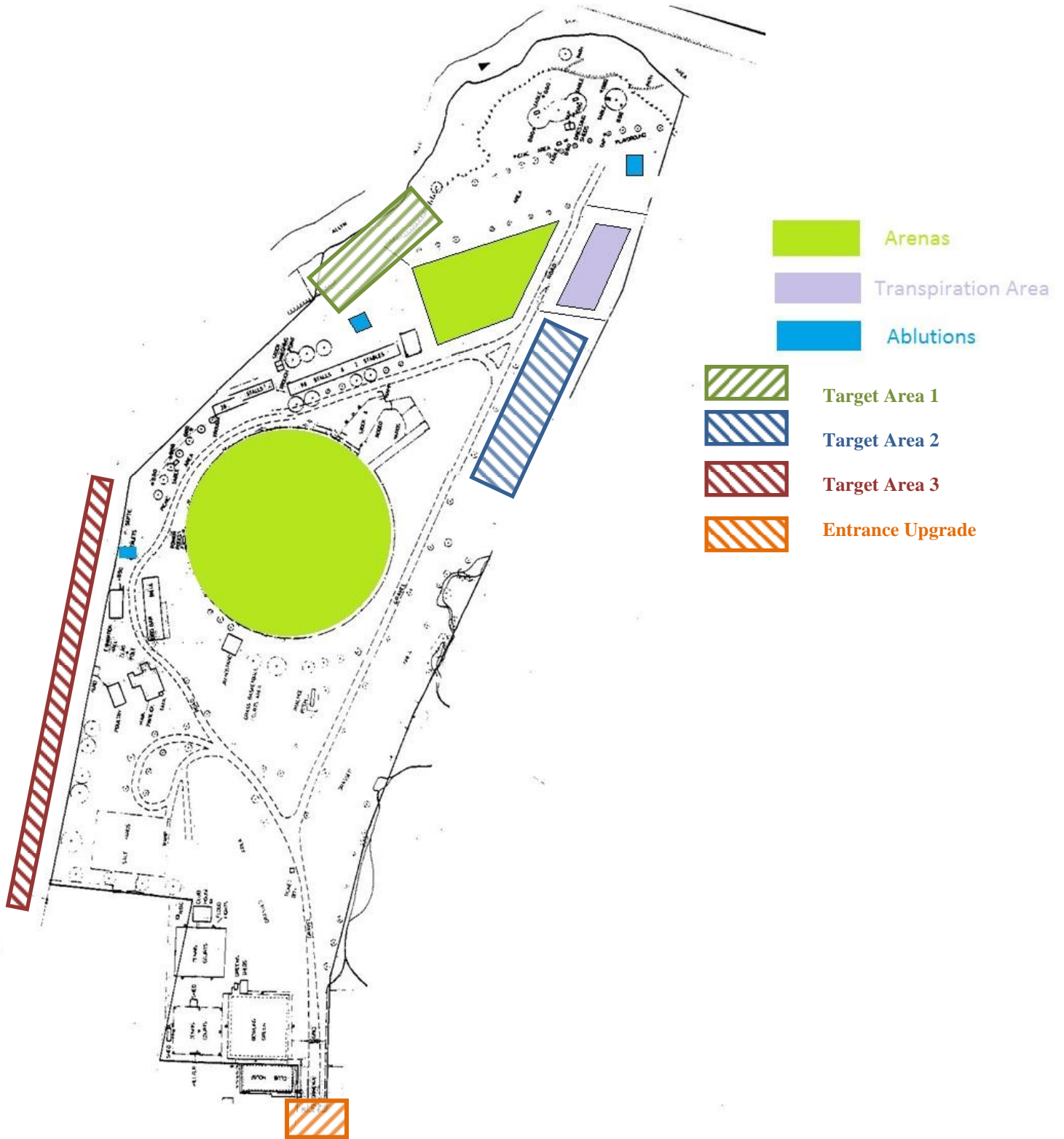

## Extension of Camping Area by Excavation and levelling of Area below Middle Toilet Block

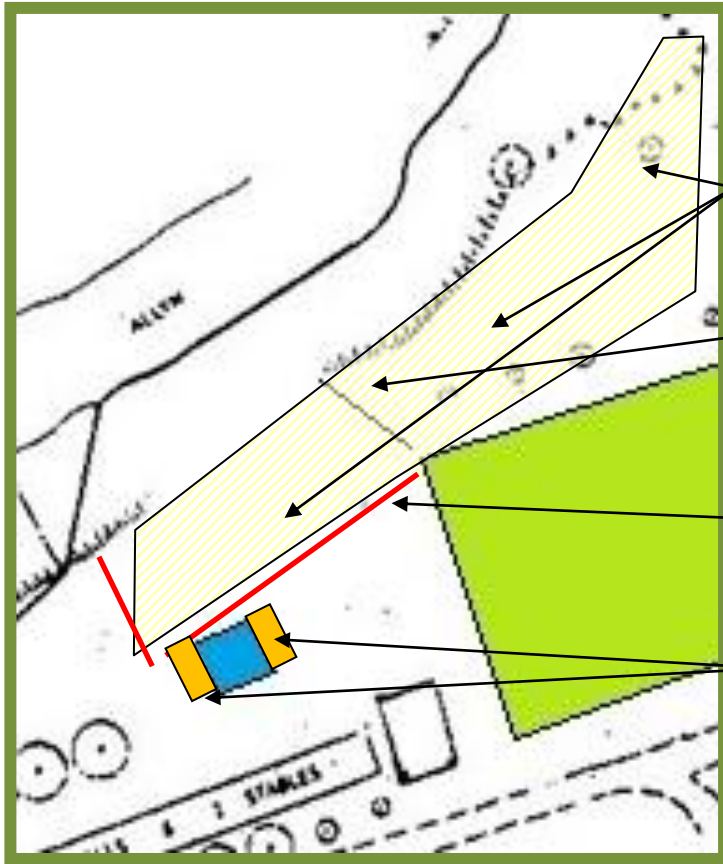

### TARGET AREA 1

Rough areas to be levelled and drainage installed July 2012

Existing fence to be removed July 2012

New fencing to be installed to delineate Camping Area July 2012

New shower facilities to be installed attached to middle toilets. (Pending Grant Application)

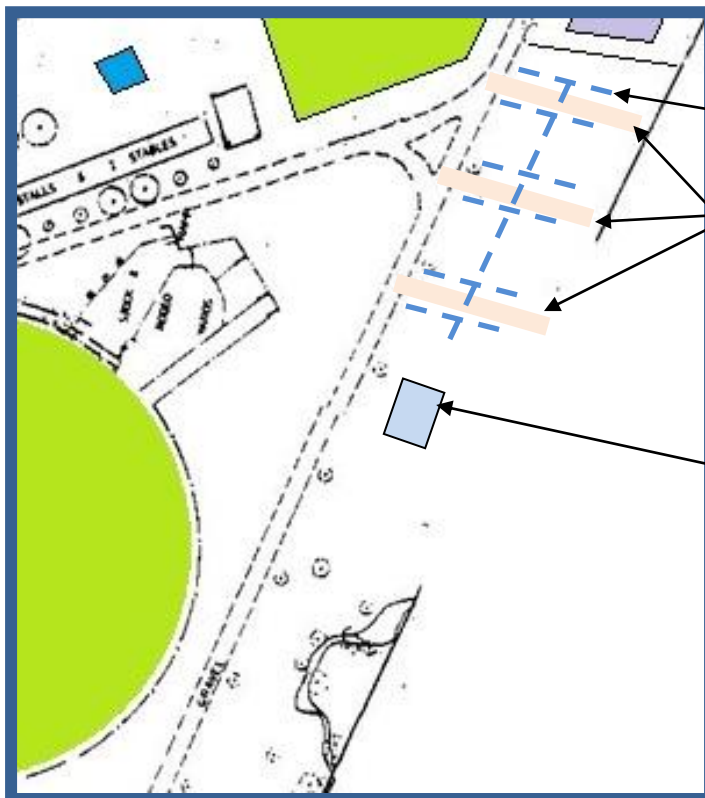

### TARGET AREA 2

Powered site access to be created. (Pending Grant Application)

Roadways to be constructed to expand parking area for competitors between road and boundary fence and to be used as overflow camping area. (Pending Grant Application)

New ablutions block to be installed. (Long term project as indicated by demand)

### TARGET AREA 3

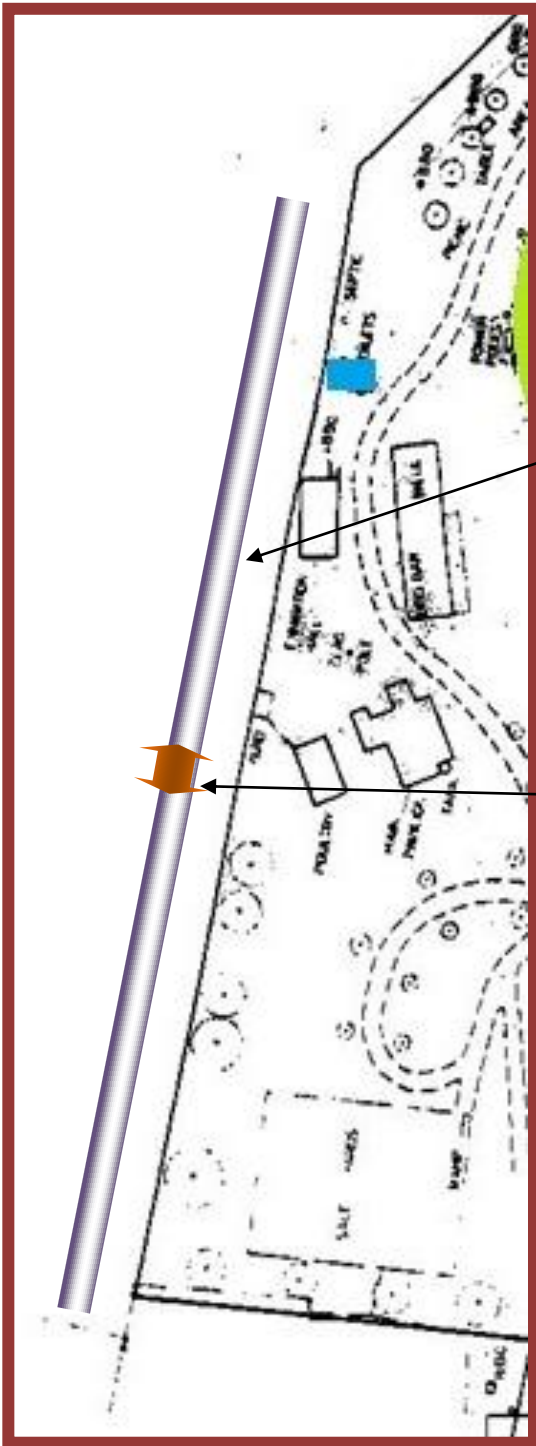

Earthen dish drain to be created to minimise water inundation from neighbouring properties

Pipe & headwalls to be installed to allow vehicular access over drain.



### ENTRANCE UPGRADE

Entrance upgrade and signage augmentation project. (Subject to grant application)